



FSHS

**Florida State
Horticultural Society**

P.O. Box 2247
Goldenrod, FL 32733-2247

Phone: (407) 673-7595 • Fax: (407) 678-6494
E-mail: FSHSociety@aol.com

Visit our website at:

valencia.lal.ufl.edu/jkbu/fshs/index.html



FSHS

**Florida State
Horticultural Society**

June 10-12, 2001

Hutchinson Island Marriott Beach Resort and Marina
STUART, FLORIDA

2 0 0 1 A G E N D A



Welcome
to the
One Hundred and Fourteenth
Annual Meeting
of the
Florida State
Horticultural Society

Hutchinson Island Marriott
Beach Resort & Marina
555 N. E. Ocean Blvd.
Stuart, FL 34996
(561) 225-3700



FSHS Board of Directors

Chairman of the Board:

Will Waters

President:

Fred Davies

Secretary:

Sal Locascio

Treasurer:

Norman Todd

Editor:

George Fitzpatrick

Newsletter Editor:

Dave Palmer

Board Members-at-Large:

Richard Campbell

Elizabeth Baldwin

Publicity Chairman:

Scott Emerson

Administrative Assistant:

Kathy Murphy

Program Coordinator:

Jackie Burns

**Hutchinson Island Marriott
Beach Resort & Marina Site Map**

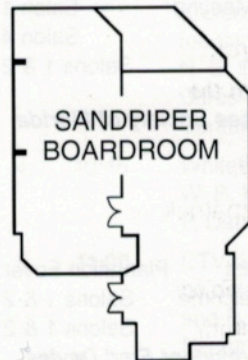
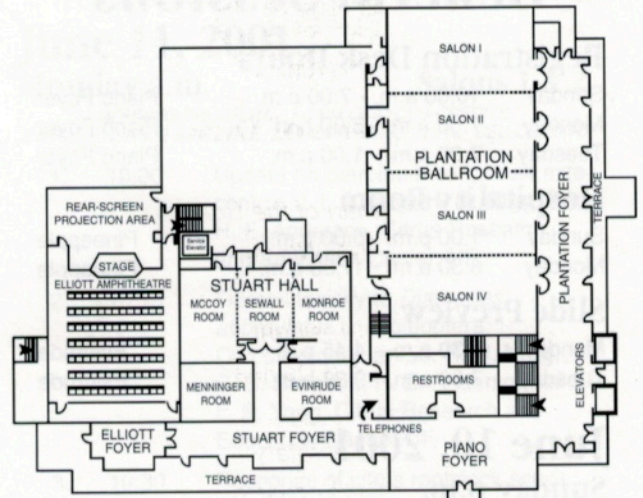

SANDPIPER BOARDROOM

LOCATED IN THE SANDPIPER BUILDING AT THE OCEAN

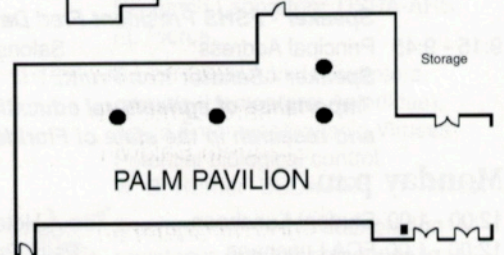

PALM PAVILION

LOCATED IN THE RIVERSIDE BUILDING

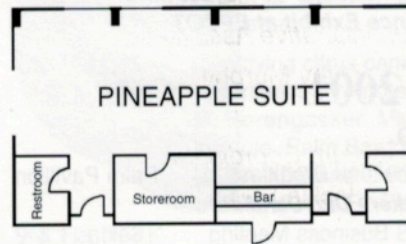

PINEAPPLE SUITE

LOCATED IN THE MAIN BUILDING

FSHS Program & General Sessions

Registration Desk Hours

Sunday	10:00 a.m. - 7:00 p.m.	Piano Foyer
Monday	7:00 a.m. - 5:00 p.m.	Piano Foyer
Tuesday	7:00 a.m. - 1:00 p.m.	Piano Foyer

Hospitality Room

Sunday	1:00 p.m. - 5:00 p.m.	Pineapple
Monday	8:30 a.m. - 11:30 a.m.	Pineapple

Slide Preview

Monday	7:30 a.m. - 4:45 p.m.	Evinrude
Tuesday	7:30 a.m. - 9:30 a.m.	Evinrude

June 10, 2001

Sunday p.m.

2:00	Board of Directors Meeting	Salon 1
6:00	Awards Ceremony	Salon 4
7:30	Welcome Reception	Salons 1 & 2

Joint reception with the Soil & Crop Sciences Society of Florida

June 11, 2001

Monday a.m.

7:00 - 8:00	Continental Breakfast	Plantation Foyer
8:30 - 8:45	Introduction and Welcome	Salons 1 & 2
8:45 - 9:15	Presidential Address	Salons 1 & 2
	Speaker - FSHS President Fred Davies	
9:15 - 9:45	Principal Address	Salons 1 & 2
	Speaker - Senator Ken Pruitt:	
	'Importance of agricultural education and research in the state of Florida'	

Monday p.m.

12:00 - 1:00	Student Luncheon	Hotel Pool
12:00 - 1:00	FCA Luncheon	Palm Pavillion
	Speaker - Bob Osterberg, Science Communicator of the Beautiful Science Exhibit at EPCOT	

June 12, 2001

Tuesday a.m.

7:00 - 8:00	Horticultural Breakfast	Palm Pavillion
	Speaker - Dan Cantliffe	
10:15 - 11:30	FSHS Business Meeting	Salons 1 & 2

Citrus Section

Megh Singh, Presiding

June 11, 2001

Monday a.m.

Salons 1 & 2

MORNING PROGRAM - 2.0 PM CCA* CEU CREDITS:
2.5 PRIVATE AG, 2.5 AG TREE, 2.5 DEMO & RES RUPAL* CEU CREDITS

1. 10:00 Update on petroleum oil for rust mite control. J. L. Knapp, **H. N. Nigg**, and H. E. Anderson, Citrus Research and Education Center, UF.
2. 10:15 Fipronil toxicity to *Diaprepes abbreviatus* L. (Coleoptera: Curculionidae) larvae. **H. N. Nigg**, S. E. Simpson, H. E. Anderson, and L. K. Yang, Citrus Research and Education Center, UF.
3. 10:30 Response of citrus rootstock seedlings to *Diaprepes abbreviatus* L. (Coleoptera: Curculionidae) larval feeding. **H. N. Nigg**, S. E. Simpson, N. E. El-Gholl, and F. G. Gmitter, Jr., Citrus Research and Education Center, UF.
4. 10:45 Whitefly Iridovirus. **C. L. McKenzie**, W. B. Hunter, S. L. Lapointe, and P. Dang, USDA-ARS, Ft. Pierce.
5. 11:00 CTV decline source budwood can be detected by grafting. **M. Bausher** and R. Niedz, US Horticultural Research Laboratory, USDA-ARS, Ft. Pierce.
6. 11:15 Brown Citrus Aphid, *Toxoptera citricida* (Homoptera: Aphididae), Aphid Entomopathogenic Viruses - Potential biological control. **W. B. Hunter**, USDA-ARS, Ft. Pierce.
7. 11:30 A comparison of five sour orange rootstocks and their response to Citrus Tristeza Virus. **K. D. Bowman** and S. M. Garnsey, USDA-ARS, Ft. Pierce.
8. 11:45 Identifying citrus canker with hyperspectral remote sensing. **M. Borengasser**, Midwest Research Institute, Palm Bay; T. R. Gottwald, USDA-ARS and T. Riley, USDA-APHIS, Ft. Pierce.

LUNCH BREAK

June 11, 2001

Monday p.m.

Salons 1 & 2

AFTERNOON PROGRAM - 1.5 PM + 1.5 CM CCA* CEU CREDITS:
3.5 PRIVATE AG, 3.5 AG TREE, 3.5 DEMO & RES RUPAL* CEU CREDITS

- 1:15 SECTIONAL BUSINESS MEETING
9. 1:30 Salinity effect on seedling emergence, nitrogen and chloride concentrations, and growth of citrus rootstocks. **M. Zekri**, Hendry County Cooperative Extension Service, UF.
10. 1:45 Foliar K application to 'Valencia' oranges. **B. J. Boman**, Indian River Research and Education Center, UF.
11. 2:00 Very frequent fertigation does not affect tree growth, fruit yield, nitrogen uptake and leaching losses from lysimeter-grown citrus trees. **J. P. Syvertsen** and **J. L. Jifon**, Citrus Research and Education Center, UF.
12. 2:15 Effect silicon fertilization for citrus. **V. V. Matichenkov**, E. A. Bocharnikova, and D. V. Calvert, Indian River Research and Education Center, UF.
13. 2:30 Wastewater and reclaimed water - Disposal problem or potential resource? **L. R. Parsons**, K. T. Morgan, T. A. Wheaton, and W. S. Castle, Citrus Research and Education Center, UF.
14. 2:45 Residual effects of Micromite (Diflubenzuron) treated citrus leaves on *Diaprepes abbreviatus* (L.) (Coleoptera: Curculionidae) egg masses. **R. C. Adair, Jr.**, Kerr Center for Sustainable Agriculture, Inc., Vero Beach.
- 3:00-3:30 DISCUSSION AND INTERMISSION
15. 3:30 Use of expressed sequence tags for horticultural problems at the US Horticultural Research Laboratory. **M. G. Bausher**, R. Shatters, R. Niedz, G. McCollum, J. Chaparro, W. Hunter, R. Mayer, P. Dang, and B. McKendree, USDA-ARS, Ft. Pierce.
16. 3:45 USDA 77-19 Grapefruit hybrid. **J. X. Chaparro**, USDA-ARS, Ft. Pierce.

17. 4:00 Normalizing in vitro development of sweet orange somatic embryos using semi-permeable membranes. **R. P. Niedz** and M. G. Bausher, USDA-ARS, Ft. Pierce.
18. 4:15 Spray variable effects on deposition and abscission efficacy of CMN-pyrazole used in mechanical harvesting of Florida orange. **E. BenSalem**, **M. Salyani**, and J. D. Whitney, Citrus Research and Education Center, UF.
19. 4:30 Measuring the impact of trunk shaking on next year's Valencia crop. **R. Rouse** and **F. Roka**, Southwest Research and Education Center, UF.
20. 4:45 Gibberellic acid wash-off studies on 'Hamlin' orange. **M. W. Fidelibus** and F. S. Davies, Horticultural Sciences Department, UF.

June 12, 2001

Tuesday a.m.

Salons 1 & 2

MORNING PROGRAM - 1.0 CM CCA* CEU CREDITS:
1.0 PRIVATE AG, 1.0 AG TREE, 1.0 DEMO & RES RUPAL* CEU CREDITS

21. 8:30 Bud union incompatibilities and associated declines observed in Florida in trees on Swingle citrumelo and other trifoliolate orange-related rootstocks. **S. M. Garnsey**, W. S. Castle and D. P. H. Tucker, Citrus Research and Education Center; R. E. Rouse, Southwest Research and Education Center, UF; and M. C. Kesinger, DPI, FDACS, Winter Haven.
22. 8:45 Poor self-pollination of Ambersweet orange is related to lack of viable pollen. **L. G. Albrigo** and D. S. Achor, Citrus Research and Education Center, UF and R. V. Russ, Russ Apiary, Haines City.
23. 9:00 Influence of different adjuvants on glyphosate efficacy on some weeds. **M. Singh** and S. D. Sharma, Citrus Research and Education Center, UF.
24. 9:15 Hurricane planning for Florida citrus groves. **R. E. Rouse**, Southwest Florida Research and Education Center, UF.

25. 9:45 Grower costs of having citrus canker in Florida with an overview of Argentina's citrus canker control program. **R. P. Muraro**, Citrus Research Education Center; F. M. Roka, Southwest Florida Research and Education Center; T. H. Spreen, Food and Resource Economics Department, UF.

Garden & Landscape Section

Peggy Dessaint, Presiding

June 11, 2001

Monday a.m.

Salon 3

MORNING PROGRAM - 0.5 CM CCA* CEU CREDITS:
2.0 PRIVATE AG, 2.0 O & T RUPAL* CEU CREDITS

26. 10:00 Florida House annual survey shows changes in landscape practices. **M. E. Shelby**, Sarasota County Cooperative Extension Service, UF.
27. 10:15 Florida House children's resource conservation tour program. **M. E. Shelby**, Sarasota County Cooperative Extension Service, UF.
28. 10:30 Northeast Florida yards, neighborhoods and ponds: protecting Florida's natural resources through environmentally-friendly landscaping and lawn care. **R. McNair**, Environmental Horticulture Department, UF.
29. 10:45 Recommended plants for south 'Florida yards' and 'Florida landscapes.' **J. Haynes**, A. Hunsberger, J. McLaughlin, and L. Vasquez, Miami-Dade Cooperative Extension Service, UF.
30. 11:00 The landscape game: teaching 'Florida friendly' landscape design principles to homeowners. **P. Grace**, Putnam County Cooperative Extension Service, UF.
31. 11:15 Youth involvement in Florida Yards program through Envirothon. **D. F. Culbert**, Indian River County Cooperative Extension Service; C. C. Bailey, E. Gastright, Martin

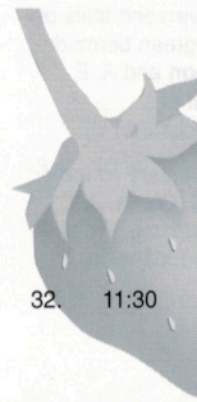

- County Cooperative Extension Service; R. H. Baker, Florida Medical Entomology Laboratory, UF; B. Schmit, Florida Department of Environmental Protection, Jensen Beach; B. Gambino, Indian River County Parks and Recreation Department, Vero Beach, and K. Stickrath, South Florida Water Management District, Okeechobee.

32. 11:30 Florida-friendly landscape tips information kiosk: an interactive touch-screen system developed by Pinellas County Florida Yards & Neighborhoods and Urban Horticulture. **D. W. Armstrong**, V. Bryant, C. Claus, O. Schallmo, Pinellas County Cooperative Extension Service, UF, and J. Bradshaw, City of St. Petersburg Public Utilities Department.
33. 11:45 *Quercus asphaltus*, or, growing 31 varieties of potted oak trees in my Miami warehouse parking lot! **L. Sinoff**, CREATIVITY WORKSHOP / Ideas & Solutions, THE REVOLVING GARDEN / Discounted Potting Supplies by Mail-Order, Miami, FL.

LUNCH BREAK

June 11, 2001

Monday p.m.

Salon 3

AFTERNOON PROGRAM - 1.0 CM CCA* CEU CREDITS:
1.5 PRIVATE AG, 1.5 O & T RUPAL* CEU CREDITS

- 1:15 SECTIONAL BUSINESS MEETING Garden and Landscape and Ornamental Sections
34. 1:30 Evaluation of thirty daffodils for use in Central Florida. **R. H. Stamps**, D. R. Rock, J. P. Carris and D. R. Graeber, Mid-Florida Research and Education Center, UF.
35. 1:45 IPM as a pest management strategy in a landscape setting. **S. A. Shives** and F. M. Melton, Manatee County Cooperative Extension Service, UF.
36. 2:00 Culture methods for optimum production of seedlings of pond apple. L. A. Gettys and **D. L. Sutton**, Fort Lauderdale Research and Education Center, UF.

37. 2:15 2000-2001 winter overseed trials on fairway and putting green bermudagrass. **S. F. Anderson** and A. E. Dudeck, Department of Environmental Horticulture, UF.
38. 2:30 Restoration of Anniversary Island's native ecosystem. **C. Claus**, J. C. Alleyne, and D. Armstrong, Pinellas County Cooperative Extension Service, UF.

June 12, 2001 Tuesday a.m.

Salon 3

MORNING PROGRAM - 0.5 CM CCA* CEU CREDITS

39. 8:00 The evolution of production and marketing techniques for radishes from Stephen's Produce "garden fresh" vegetables at local green markets in Palm Beach County, Florida, 1996-2001. **K. D. Shuler**, S. J. Nie, and P-A. N. Shuler, Stephen's Produce, Jupiter, FL.
40. 8:15 The evolution of production and marketing techniques for bok choy Chinese cabbage from Stephen's Produce "garden fresh" vegetables at local green markets in Palm Beach County, Florida, 1996-2001. **K. D. Shuler**, S. J. Nie, and P-A. N. Shuler, Stephen's Produce, Jupiter, FL.

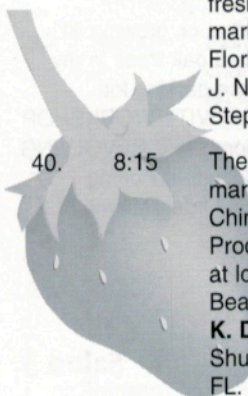

Handling & Processing Section

Renée Goodrich, Presiding

June 11, 2001 Monday a.m.

Menninger

41. 10:00 Postharvest firmness measurements of blueberry fruit using a non-destructive method. **A. C. O. Ferraz**, FEAGRI, State University of Campinas, Campinas, São Paulo, Brazil; A. J. Fox and S. A. Sargent, Horticultural Sciences Department, UF.

42. 10:15 Characterization of fresh tomato aroma volatiles using GC-olfactometry. K. S. Tandon, M. Jordan, K. L. Goodner and **E. A. Baldwin**, USDA/ARS, Winter Haven.
43. 10:30 Scheduling tomato fruit ripening with 1-MCP. **C. L. Moretti**, Embrapa Vegetables, Brasília, Federal District, Brazil; R. M. Souza, A. L. Araújo, University of Brasília, Federal District, Brazil; and L. M. Mattos, Federal University of Lavras, Lavras, Minas Gerais, Brazil.
44. 10:45 Immersion in heated water doesn't soften ripening tomatoes. A. J. Fox and **S. A. Sargent**, Horticultural Sciences Department, UF.
45. 11:00 Respiratory activity and enzymatic browning of minimally processed sweet potatoes. **C. L. Moretti**, Embrapa Vegetables, Brasília, Federal District, Brazil; and L. M. Mattos, Federal University of Lavras, Minas Gerais, Brazil.
46. 11:15 Volatile components in banana (*Musa sapientum* L.) and yellow passion fruit (*Passiflora edulis* Sims f. *Flavicarpa degneri*) as determined by GC-MS and GC-olfactometry. **M. Jordán**, K. L. Goodner, and P. E. Shaw, USDA/ARS, Winter Haven.
47. 11:30 The comparison of an electronic nose and gas chromatograph for differentiating NFC orange juices. **K. L. Goodner**, E. A. Baldwin, M. J. Jordán, and P. E. Shaw, USDA/ARS, Winter Haven.
48. 11:45 Fresh-cut sweetcorn kernels. **G.S. Riad** and J. K. Brecht, Horticultural Sciences Department, UF.

LUNCH BREAK

June 11, 2001 Monday p.m.

Menninger

- 1:15 SECTIONAL BUSINESS MEETING
49. 1:30 Postharvest factors influencing stem end rind breakdown (SERB) of 'Valencia' oranges. **H. Dou**,

J. Zhang, and M. A. Ismail, Florida Department of Citrus, Lake Alfred; M. A. Ritenour, Indian River Research and Education Center, UF.

50. 1:45 Ethanol content of 'Murcott' tangerines harvested at different times and treated with coatings of different O₂ permeability. **R. D. Hagenmaier**, USDA/ARS, Winter Haven.
51. 2:00 The 'Juice HACCP Rule.' **R. M. Goodrich**, Citrus Research and Education Center, UF.
52. 2:15 Comparing attachment strength, heat tolerance and alkali resistance of pathogenic and non-pathogenic bacteria on orange surfaces. **S. Pao** and C. Davis, Florida Department of Citrus, Lake Alfred.
53. 2:30 Investigation of the microflora on orange fruit surfaces in a processing facility. **M. E. Parish**, R. M. Goodrich, J. A. Narciso, and L. M. Friedrich, Citrus Research and Education Center, UF.
- 3:00-3:30 Discussion and Intermission
54. 3:30 Has mechanical harvesting become an economical alternative for harvesting Florida citrus? **F. M. Roka**, Southwest Florida Research and Education Center; G. Brown, Florida Department of Citrus, Lake Alfred; and R. Muraro, Citrus Research and Education Center, UF.
55. 3:45 Effects of moderate shade on citrus leaf gas exchange, fruit yield and quality. **J. L. Jifon** and J. P. Syvertson, Citrus Research and Education Center, UF.
56. 4:00 Evaluation of refrigerated conditions and fruit quality in cooling fresh Florida citrus. **W. M. Miller**, Citrus Research and Education Center; M. Talbot, Agricultural and Biological Engineering Department, UF, and H. Dou, Florida Department of Citrus, Lake Alfred.

Krome Memorial Section

Malcolm Manners, Presiding

June 11, 2001

Monday a.m.

Salon 4

MORNING PROGRAM - 1.5 PM CCA* CEU CREDITS:
1.0 PRIVATE AG, 0.5 AG ROW, 1.0 AG TREE, 1.0 DEMO & RES,
1.0 O & T RUPAL[†] CEU CREDITS

57. 10:00 Incorporating fruit trees and other non-natives into native landscapes: increasing benefits for the home gardener. **R. J. Campbell**, Fairchild Tropical Garden, Miami.
58. 10:15 Evaluation of 'Oro' and 'Trompo' canistel (*Pouteria campechiana* Baehni) at the Tropical Research and Education Center, Homestead. **J. H. Crane**, Tropical Research and Education Center, UF.
59. 10:30 Evaluation of the green sapote (*Pouteria viridis* Cronq.) fruit at the Tropical Research and Education Center, Homestead. **J. H. Crane**, Tropical Research and Education Center, UF.
60. 10:45 Phytophthora root rot-resistant avocado rootstocks for south Florida: selection of open-pollinated seedling progeny. **R. Ploetz**, J. Haynes, Tropical Research and Education Center, UF, and R. Schnell, USDA/ARS, Miami.
61. 11:00 Publicly funded promotional programs for fruit and vegetable commodities: a national survey of state departments of agriculture. **K. L. Morgan**, R. N. Muruli, R. L. Degner, and A. Wysocki, Food and Resource Economics Department, UF.
62. 11:15 Variation in response of somatic embryos and plantlets of sugarcane cultivars to G418 selection. **Z. Ying** and M. J. Davis, Tropical Research and Education Center, UF.
63. 11:30 Relationship between Florida freeze incidence and sea surface temperature in the Tropical Pacific. **J. D. Martsof**, Horticultural Sciences Department, UF.

* CCA: Certified Crop Advisors

[†] RUPAL: Restricted Use Pesticide Applicators License

64. 11:45 Effect of emitter patterns and soil type on soil water distribution through the rootzone. **A. Fares**, L. R. Parsons, T. A. Wheaton, and K. Morgan, Citrus Research and Education Center, UF.

LUNCH BREAK

June 11, 2001
Monday p.m.

Salon 4

AFTERNOON PROGRAM - 1.5 CM CCA* CEU CREDITS:
1.0 PRIVATE AG, 0.5 AG ROW, 1.0 DEMO & RES,
0.5 O & T RUPAL[†] CEU CREDITS

- 1:15 SECTIONAL BUSINESS MEETING
65. 1:30 Market Windows for Florida Blueberries. **P.M. Lyrene**, Department of Horticultural Sciences, UF.
66. 1:45 Timing and concentration of hydrogen cyanamide sprays affect bud development, flower mortality, and hasten fruit maturity of blueberry. **J. G. Williamson** and B. E. Maust, Department of Horticultural Sciences, UF, and D. S. NeSmith, Horticulture Department, Griffin, GA.
67. 2:00 Characteristics of plums from the University of Florida breeding program. **W. B. Sherman**, and R. E. Rouse, Southwest Florida Research and Education Center, UF.
68. 2:15 Low Chill Peach and Nectarine Cultivars from the University of Florida Breeding Program: 50 Years of Progress. P. C. Andersen, North Florida Research and Education Center; **W. B. Sherman** and J. G. Williamson, Horticultural Sciences Department, UF.
69. 2:30 Searching for parthenocarpy in Southern Highbush Blueberry (*Vaccinium corymbosum* L.) **W. C. Kazokas** and P. M. Lyrene, Horticultural Sciences Department, UF.
70. 2:45 Assessment of moderate-chill peach varieties for the southeastern lower coastal plain. **K. C. Taylor**,

Southeastern Stone Fruit and Tree Nut Laboratory; T. Beckman, USDA-ARS, University of Georgia; B. G. Krewer, Rural Development Center, Tifton, GA, and W. Sherman, Horticultural Sciences Department, UF.

Ornamentals Section

Everett Emino, Presiding

June 11, 2001
Monday p.m.

Salon 3

AFTERNOON PROGRAM - 1.5 PM CCA* CEU CREDITS:
2.0 PRIVATE AG, 2.0 DEMO & RES, 2.0 O & T RUPAL[†] CEU CREDITS

- 1:15 SECTIONAL BUSINESS MEETING: Garden and Landscape and Ornamental Sections
71. 2:45 Challenges in academic advisement for horticulture students at the University of Florida's satellite campuses. **K. K. Moore**, G. E. Fitzpatrick, and J. E. Slane, Fort Lauderdale Research and Education Center, UF.
- 3:00-3:30 Discussion and Intermission
72. 3:30 Seed pathology of native scrub grasses. **C. C. Bailey**, Marin County Cooperative Extension Service, UF, and J. J. Muchovej, Ornamental Horticulture Department, Florida A&M University, Tallahassee.
73. 3:45 Downey mildew of *Salvia splendens* caused by *Peronospera lamii*. **T. F. Wood**, R.T. McMillan, Jr., and W. R. Graves, Tropical Research and Education Center, UF.
74. 4:00 Host suitability of some vinca and salvia cultivars to two isolates of root-knot nematodes. **R. McSorley** and J. J. Frederick, Department of Entomology and Nematology, UF.
75. 4:15 Growth control of *Salvia* x 'Indigo Spires' by photosensitive plastic films. **L. A. Krumfolz**, S. B. Wilson, Indian River Research and Education Center, UF, and N. C. Rajapakse, Department of Horticulture, Clemson University, Clemson, SC.

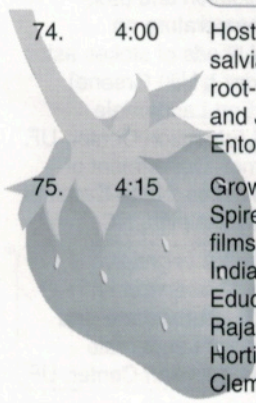

76. 4:30 A multi-cavity collection method for plug root-zone solution extraction. **Y. Huang**, J. Chen, C. A. Robinson and R. D. Caldwell, Mid-Florida Research and Education Center, UF.
77. 4:45 Awn removal of native scrub grasses. **C. C. Bailey**, Marin County Cooperative Extension Service, UF, and J. J. Muchovej, Ornamental Horticulture Department, Florida A&M University, Tallahassee.
78. 5:00 New miticides for control of two-spotted spider mite on ornamentals. **J. F. Price**, Gulf Coast Research and Education Center, UF.
79. 5:15 Production of potted Ranunculus in Central Florida. **J. L. Griffis, Jr.** and M. M. Manners, Citrus and Environmental Horticulture Department, Florida Southern College, Lakeland.

June 12, 2001

Tuesday a.m.

Salon 3

MORNING PROGRAM - 1.5 CM CCA* CEU CREDITS:
2.0 PRIVATE AG, 2.0 DEMO & RES, 2.0 O & T RUPAL[†] CEU CREDITS

80. 8:30 Assessment of germination, nutrient uptake and photosynthetic efficiency for evaluating the potential invasiveness of *Ruellia brittoniana*. **S. B. Wilson**, P. C. Wilson, Indian River Research and Education Center, UF, and M. E. Tignor, Department of Plant and Soil Science, University of Vermont, Burlington, VT.
81. 8:45 Effect of stratification and post-stratification temperature on germination of seeds of Stokes aster [*Stokesia laevis* (J. Hill) Greene]. **L. A. Gettys**, Fort Lauderdale Research and Education Center, UF, and D. J. Werner, Department of Horticultural Science, North Carolina State University, Raleigh, NC.
82. 9:00 Media influence for vegetative propagation of *Mussaenda erythrophylla*. **A. Sutherland** and G. Fitzpatrick, Fort Lauderdale Research and Education Center, UF.

* CCA: Certified Crop Advisors
† RUPAL: Restricted Use Pesticide Applicators License
△ Best Student Paper Competition

83. 9:15 Culture and production of pickerel-weed utilizing three different substrates. **L. A. Gettys**, S. J. Peters, and D. L. Sutton, Fort Lauderdale Research and Education Center, UF.
84. 9:30 Turf response to coated-urea fertilizers. **J. L. Cisar**, Fort Lauderdale Research and Education Center; G. H. Snyder, Everglades Research and Education Center; J. J. Haydu, Mid-Florida Research and Education Center, and K. E. Williams, Fort Lauderdale Research and Education Center, UF.
85. 9:45 Solarization of spent media for bedding plants production. **G. M. Zinati** and H. H. Bryan, Tropical Research and Education Center, UF.

Vegetable Section

J. Marion White, Presiding

June 11, 2001

Monday a.m.

Elliott Amphitheater

MORNING PROGRAM - 2.0 PM CCA* CEU CREDITS:
2.5 PRIVATE AG, 2.5 AG ROW, 2.5 DEMO & RES RUPAL[†] CEU CREDITS

86. 10:00 The southwest Florida pest and disease hotline - An Extension Success Story. **E. McAvoy**, Hendry County Cooperative Extension Service, UF.
87. 10:15 The potential for use of biologically-based disease management products in Florida vegetable production. **E. M. Lamb**, Indian River Research and Education Center, UF, and E. N. Roskopf, USDA-ARS, Ft. Pierce.
88. 10:30 Effect of metam sodium and methyl bromide on root-knot nematode, yellow nutsedge and damp-off on cucumber cv. Dasher II. **R. T. McMillan, Jr.** and H. H. Bryan, Tropical Research and Education Center, UF.

* CCA: Certified Crop Advisors
† RUPAL: Restricted Use Pesticide Applicators License

89. 10:45 Distance between yellow nutsedge (*Cyperus esculentus*) and polyethylene-mulched bell pepper (*Capsicum annuum*) at which interference is minimal and maximal. **T. N. Motis**, S. J. Locascio, Horticultural Sciences Department, and J. P. Gilreath, Gulf Coast Research and Education Center, UF. ^Δ
90. 11:00 Competition of smooth amaranth (*Amaranthus hybridus*) and livid amaranth (*A. lividus*) with cucumber. **A. D. Berry**, W. M. Stall, B. Rathinasabapathi, Horticulture Sciences Department, G. E. MacDonald, Agronomy Department, and R. Charudattan, Plant Pathology Department, UF. ^Δ
91. 11:15 Influence of the biostimulant folcysteine on the interference of purple nutsedge (*Cyperus rotundus* L.) with eggplant (*Solanum melongena* L.) **J. P. Morales-Payan** and W. M. Stall, Horticultural Sciences Department, UF.
92. 11:30 Progress toward developing new insecticides and miticides for spider mites in strawberry. **J. F. Price**, Gulf Coast Research and Education Center, UF.
93. 11:45 An economic assessment of pre-harvest fungicide applications to control Botrytis Fruit Rot in annual strawberries. **J. J. Haydu**, Mid-Florida Research and Education Center, and D. E. Legard, Gulf Coast Research and Education Center, UF.

LUNCH BREAK

June 11, 2001
Monday p.m. Elliott Amphitheater

AFTERNOON PROGRAM – 1.0 NM, 1.0 CM CCA* CEU CREDITS:
2.5 PRIVATE AG, 2.5 AG ROW, 2.5 DEMO & RES RUPAL† CEU CREDITS

- 1:15 SECTIONAL BUSINESS MEETING
94. 1:30 The rise and fall of the Florida celery industry from 1895 to 1995. **G. M. Talbott**, Florida Celery Exchange, Winter Park, FL.
95. 1:45 A decade of change in Florida's greenhouse vegetable industry: 1991-2001. **R. V. Tyson**, Seminole

- County Cooperative Extension Service; B. C. Hochmuth, North Florida Research and Education Center, Suwannee Valley; G. J. Hochmuth, North Florida Research and Education Center, Quincy, and M. S. Sweat, Baker County Cooperative Extension Service, UF.
96. 2:00 Competitiveness of the Spanish and Dutch greenhouse industries with the Florida fresh vegetable industry. **D. J. Cantliffe** and J. H. Vansickle, Horticultural Sciences Department, UF.
97. 2:15 Hydroponically produced "Galia" muskmelon – What's the secret? **N. L. Shaw**, D. J. Cantliffe, and S. Taylor, Horticultural Sciences Department, UF.
98. 2:30 Improving lettuce transplant quality in response to nitrogen nutrition in a floatation production system. **P. Soundy** and D. J. Cantliffe, Horticultural Sciences Department, UF.
99. 2:45 Performance of greenhouse tomato varieties grown in soilless culture in north central Florida. **J. C. Rodriguez**, D. J. Cantliffe and N. Shaw, Horticultural Sciences Department, UF. ^Δ
- 3:00-3:30 Discussion and Intermission
100. 3:30 Growth and development of carrot on organic soils in Florida. **J. Strandberg**, Mid-Florida Research and Education Center, UF.
101. 3:45 Muskmelon fruit yield response to K source and method of application. **G. J. Hochmuth**, North Florida Research and Education Center, and M. Gal, Horticultural Sciences Department, UF.
102. 4:00 Interactions between nitrogen rates and cultivar on the yield of strawberry. **E. J. Simonne**, Horticultural Sciences Department, J. R. Duval and E. Golden, Gulf Coast Research and Education Center, UF.
103. 4:15 Sulfur fertilization for polyethylene-mulched cabbage. **A. D. Susila** and S. J. Locascio, Horticultural Sciences Department, UF. ^Δ

104. 4:30 A comparison of resistance to gas diffusion through the seedcoat and hilum of triploid and diploid watermelon (*Citrullus lanatus* Matsum & Nakai). **J. R. Duval**, Gulf Coast Research and Education Center, UF; D. S. NeSmith and M. Rieger, Department of Horticulture, University of Georgia, Athens, GA.
105. 4:45 Response of 'Florida 47' tomato to seed and foliar applications of 'silk' biostimulant. **A. A. Csizinsky**, Gulf Coast Research and Education Center, UF.

June 12, 2001

Tuesday a.m. Elliott Amphitheater

MORNING PROGRAM - 1.0 CM CCA* CEU CREDITS:
1.5 PRIVATE AG, 1.5 AG ROW, 1.5 DEMO & RES RUPAL' CEU CREDITS

106. 8:30 Results of sweet corn variety demonstrations on organic soils. **K. D. Shuler**, Palm Beach County Cooperative Extension Service, UF.
107. 8:45 Cost comparisons of Boniato in Miami-Dade County, FL: 1980 vs. 2000. **F. Roka**, Southwest Florida Research and Education Center; M. Lamberts, Miami-Dade County Cooperative Extension Service; S. K. O'Hair, Tropical Research and Education Center, and R. Regalado, Miami-Dade County Cooperative Extension Service, UF.
108. 9:00 Greenhouse production of several fresh-cut herbs in vertical hydroponic systems in north Florida. **S. C. Stapleton** and R. C. Hochmuth, North Florida Research and Education Center, UF.
109. 9:15 Calabaza yield and size at two spacings when grown as a second crop on various plastic mulches. **J. M. White**, Mid-Florida Research and Education Center, UF.
110. 9:30 Abundance and distribution of thrips *Palmi karny* on potatoes and eggplants. **D. R. Seal**, Tropical Research and Education Center, UF.