

**WELCOME TO THE
2011 ANNUAL MEETING**

**OF THE
FLORIDA STATE
HORTICULTURAL SOCIETY**

WITH

FEATURED SPEAKERS

TECHNICAL SESSIONS

WORKSHOPS

ON

**“HOW WILL RECENT
LEGISLATIONS IMPACT FLORIDA
HORTICULTURE?”**

June 5 to 7, 2011

**Vinoy Renaissance Resort
and Golf Club
501 5th Avenue NE
St. Petersburg, FL 33701**



*** * * * ***



2011 PROGRAM CONTENTS

	Page
Program overview	3
2011 FSHS Board of Directors.....	6
2011 Meeting facilitators	7
FSHS Patron members.....	7
Displays during the meeting	8
Meeting sponsors	9
FSHS Publication and submission guidelines for oral presentations authors	10
FSHS Student competitions and awards	11
FSHS Student scholarships	11
Poster session	12
Vegetable section	14
Ornamental, garden & landscape section	18
2011 Annual meeting facts	21
Krome Memorial Institute	22
Handling & processing section	24
Citrus section	26
In-service training and producer workshop: <i>“Impact of Recent Legislation on Florida Agriculture”</i>	30
Notes	31
Vinoy Renaissance Resort map	32

* * * * *

MARK YOUR CALENDARS!

2012 FSHS ANNUAL MEETING:

Delray Beach Marriott – Beach Resort
Delray Beach, FL 33483
June 3-5, 2012

2013 FSHS ANNUAL MEETING:

Sarasota Hyatt Regency
Sarasota, FL 34236
June 2-4, 2013

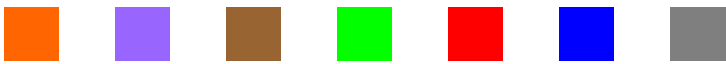

PROGRAM OVERVIEW

Registration Desk Hours	Lobby Foyer
Sunday June 5	2:00 PM - 6:30 PM
Monday June 6	7:00 AM - 6:00 PM
Tuesday June 7	7:00 AM – 11:30 AM

Sunday Afternoon

1:00-5:00	Certified Horticulturist Examination	Wylie Taylor
2:00-4:00	FSHS Board of Directors Meeting	
3:00-4:30	Posters Set up, Brad Burbaugh	Mezzanine
4:30-6:00	Opening Ceremony, Jeff Brecht	Vinoy Grand Ballroom
4:45-5:30	Opening Session Speaker: <div style="color: green; font-size: small;">Dr. Rodney Clouser, Professor and Associate Chair, UF/IFAS Food and Resource Economics Dept.</div> <p style="text-align: center; font-weight: bold; margin: 0;">“Involvement in Florida’s Local Government Public Policy Process: The Structure of Policy Involvement, A Model for Policy Involvement, The Role of Science/Academics, and Is Science/Academics the Crucial Determinant in the Policy Choice?”</p>	
5:30-6:00	Awards	
6:00-7:00	Welcome Reception <i>(Included in paid conference registration)</i>	Mezzanine

Monday Morning

7:00-8:00	Continental Breakfast <i>(Included in paid conference registration)</i>	Mezzanine
7:30-8:15	Poster Session, Brad Burbaugh (See list of posters on p. 12)	Mezzanine
8:30-9:45	General Session	Vinoy Grand Ballroom
8:30	Introduction and Welcome	
8:40	Presidential Address: Richard Tyson, FSHS President	
9:00	General Session Keynote Speaker: <div style="color: green; font-size: small;">Mr. Adam Putnam, Florida Commissioner of Agriculture,</div>	

Tallahassee, FL:

**“The Road Ahead for Florida
Agriculture”**

Questions and Answers

9:45

End of General Session

Concurrent Morning Sessions:

10:00-
11:45

Citrus (p.26)

***Vinoy Grand
Ballroom***

10:00-
11:45

Krome Memorial Institute
(p.22)

Plaza C

10:00-
Noon

Ornamental, Garden &
Landscape (p.18)

Plaza A&B

10:00-
11:45

Handling & Processing (p.24)

Plaza D

10:00-
11:45

Vegetable (p.14)

Avery/Chancellor

Monday Lunch

11:45-1:20 Lunch (*on your own*) – at Shawn’s or Alfresco’s

Monday Afternoon

Concurrent Afternoon Sessions:

1:20-4:45

Citrus

***Vinoy Grand
Ballroom***

1:20-4:30

Krome Memorial Institute

Plaza C

1:20-5:45

Ornamental, Garden &
Landscape

Plaza A&B

1:20-5:15

Handling & Processing

Plaza D

1:20-5:45

Vegetable

Avery/Chancellor

4:15-5:30

Focus Team Meeting

Avery/Chancellor

Monday Evening

6:00-7:00

Industry Reception (*Included
in paid conference
registration*)

Palm Court Foyer

Tuesday Morning

7:00-8:15

Horticultural Breakfast (*Event
ticket required*)

Fred’s

Invited Speaker:

**Ms. Mary Ann Gosa, UF/IFAS
Director of Government
Relations**

**“How can IFAS help IFAS in
the State Legislature”**

8:30-9:45

FSHS Annual Business

Vinoy Grand

Meeting: **Ballroom**
Student Competition Awards,
Jose Reyes
Historical Perspectives
Dr. Ed Etxeberria, FSHS
Member at-large:
“Historical Agritainment”

Concurrent Morning Sessions:

9:50-11:30	Citrus	Vinoy Grand Ballroom
10:00-12:00	Ornamental, Garden & Landscape	Plaza A&B
10:00-11:15	Vegetable	Avery/Chancellor
12:00	All posters are taken down	Mezzanine

Tuesday Lunch

12:00-1:15 Extension Luncheon (*Event ticket required*) **Fred's**
Invited speaker:
Mr. Ted Campbell, Executive Director, Florida Strawberry Growers Association, Plant City, FL:
“An Industry Perspective on the Impact of Recent Legislation on Florida Agriculture”

Tuesday Afternoon

1:30-5:00 In-Service Training and Producer Workshop **Vinoy Grand Ballroom**
(*Registration to UF-IFAS IST #30126 required*)
How Will Recent Legislation Impact Florida Agriculture
Co-sponsored by FSHS and UF/IFAS Cooperative Extension Service
End of 2011 Annual meeting. Have a safe trip home, and
See you next year!

VOLUNTEERS NEEDED!

FSHS is a volunteer-run organization. Make a difference, and volunteer your time, leadership, service and talents!

Visit **fshs.org** and step up!



**FLORIDA STATE HORTICULTURAL
SOCIETY
2010-2011
BOARD OF DIRECTORS**

<i>Chairman of the Board</i>	<i>Jeff Brecht</i>
<i>President</i>	<i>Richard Tyson</i>
<i>President-elect</i>	<i>Juanita Popenoe</i>
<i>Sectional Vice-presidents:</i>	
<i>Citrus</i>	<i>Ryan Atwood</i>
<i>Krome Memorial Institute</i>	<i>Gary England</i>
<i>Ornamental, Garden and Landscape</i>	<i>Mike Orfanedes</i>
<i>Handling & Processing</i>	<i>Alvin Cheng</i>
<i>Vegetable</i>	<i>Danielle Treadwell</i>
<i>Soil and Crops Session</i>	<i>Thomas Obreza</i>
<i>Secretary and Treasurer</i>	<i>Chris Oswalt</i>
<i>Proceedings Editor</i>	<i>Jan Narciso</i>
<i>2010 Sectional Editors:</i>	
<i>Citrus</i>	<i>Ed Stover</i>
<i>Krome Memorial Institute</i>	<i>Ed Etxeberria</i>
<i>Ornamental, Garden and Landscape</i>	<i>Richard Tyson</i>
<i>Handling & Processing</i>	<i>Jose Reyes</i>
<i>Vegetable</i>	<i>Sal Locascio</i>
<i>Marketing Coordinator/ Webmaster</i>	<i>Mark Ritenour</i>
<i>Members At-large</i>	<i>Fritz Roka</i>
	<i>Ed Etxeberria</i>
<i>Program Coordinator</i>	<i>Eric Simonne</i>

* * * * *

ATTENTION FSHS AUTHORS!

DID YOU KNOW?

FSHS welcomes and encourages **color pictures** and **color figures** in Proceedings articles?

Did you know that videos can also be linked to Proceedings articles?

Color pictures and figures, and videos are included **FREE of CHARGE** in the on-line Proceedings.

Take advantage of this possibility and pass the word around!



2011 MEETING FACILITATORS

<i>Meeting Coordinator</i>	<i>Tracy Shawn</i>
<i>Local Arrangements Coordinators</i>	<i>Jane Morse and Theresa Badurek</i>
<i>Sponsorship Coordinator</i>	<i>Gene Albrigo</i>
<i>Student Competitions Coordinator</i>	<i>Jose Reyes</i>
<i>CEU Coordinator</i>	<i>Barton Wilder</i>
<i>Poster Session Coordinator</i>	<i>Bradley Burbaugh</i>
<i>High School Student Video Competition Coordinator</i>	<i>David Hall</i>
<i>FSHS Newsletter Team</i>	<i>Kathy Schneider, Ed Etxeberria and Jim Syvertsen</i>

* * * * *

2011 FSHS PATRON MEMBERS

<i>Ed Etxeberria</i>	<i>Mary Lamberts</i>
<i>David J. Hall</i>	<i>Jim Syvertsen</i>

* * * * *

DON'T FORGET TO THANK OUR STUDENT SECTION ASSISTANTS!

Citrus: Eduardo Chica (echica@ufl.edu; Dr. Albrigo)

Handling & Processing: Francisco Loayza (Francisco.Loayza@ufl.edu; Dr. Brecht)

Krome Memorial Institute: Libby Rens (libbyrens@gmail.com; Dr. Treadwell)

Ornamental, Garden & Landscape: Connie Johnson (cnjuflhort82@yahoo.com; Dr. Fisher)

Vegetable: Pei-Wen Huang (agnespei@ufl.edu; Dr. Santos)

Poster: Evelyn "Prissy" Fletcher (treehugger@ufl.edu; Dr. Nkedi-Kizza)



DISPLAYS DURING THE MEETING

Mezzanine

2012 FSHS Meeting in Delray Beach, FL. *Richard Tyson, UF/IFAS Orange County Extension, Orlando, FL.*

2011 Florida Small Farms and Alternative Enterprise Conference. *Robert Hochmuth, UF/IFAS North Fla. Res. and Edu. Ctr. – Suwannee Valley, Live Oak, FL.*

The UF/IFAS Small Farms Academy. *Robert Hochmuth, UF/IFAS NFREC-SV, Live Oak, FL.*

Citrus Greening. *Jamie Yates, UF/IFAS Citrus Res. and Edu. Ctr., Lake Alfred, FL.*

UF/IFAS Pinellas County Extension Programs. *Jane Morse and Theresa Badurek, UF/IFAS Pinellas County Extension, Largo, FL.*

UF/IFAS Citrus Mechanical Harvesting and Abscission Program. *Fritz Roka and Barbara Hyman, UF/IFAS Southwest Florida Res. & Edu. Ctr., Immokalee, FL.*

UF/IFAS Analytical Services Laboratory Res. and Extension Services. *Rao Mylavaram, UF/IFAS Soil and Water Science Dept., Gainesville, FL.*

* * * * *

WELCOME 2011 FSHS SECTIONAL VICE-PRESIDENTS!

Citrus: Fritz Roka, UF/IFAS Southwest Florida Research and Education Center, Immokalee, FL.
(fmroka@ufl.edu)

Handling & Processing: Gregg McCollum, USDA/ARS Horticultural Research Laboratory, Ft. Pierce, FL.
(gmccollum@ushrl.ars.usda.gov)

Ornamental, Garden, & Landscape: Jane Morse, UF/IFAS Pinellas County Extension, Largo, FL.
(jvmorse@ufl.edu)

Krome Memorial Institute: Gary England, UF/IFAS Sumter County Extension, Bushnell, FL. (gke@ufl.edu)

Vegetables: David Sui, UF/IFAS Palm Beach County Extension, West Palm Beach, FL. (dsui@ufl.edu)



2011 MEETING SPONSORS

Gold Level Sponsor (above \$2,000)

**Citrus Research and
Development Foundation**

Yara North America

Silver Level Sponsor (\$1,000–1,999)

Bayer CropSciences

(Sponsor of Vegetable Section Best Paper Award)

Helena

(Sponsor of Citrus Section Best Paper Award)

UF/IFAS Soil and Water Science Dept.

Valent BioSciences Corporation

*(Sponsor of Krome Memorial Institute Section Best
Paper Award)*

Bronze Level Sponsor (\$500–\$999)

Chemical Dynamics

Syngenta

Triangle Chemical Company

Pewter Level Sponsor (under \$500)

AgraQuest

BASF Chemicals

Chemtura AgroSolutions

McLean Ag Chemicals

**Thank
You** *Mahalo*
Tack **Kiitos**
Grazie *Toda* **Thanks**
Takk **Gracias** **Merci**

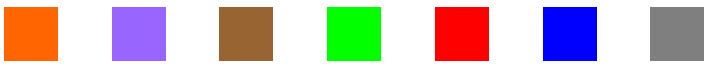

FSHS PRESENTATION, PUBLICATION AND SUBMISSION GUIDELINES

Full payment of page charges from past years (<http://shop.ashs.org/home.php?cat=270>) is required before presentations and submissions can be accepted in current year.

The SENIOR AUTHOR must be a member of the Society, and the PRESENTING AUTHOR of the paper must be registered at the annual meeting (except for invited papers) for papers to be accepted for the Proceedings. Papers not presented at the meeting will not be published.

Electronic submissions are highly encouraged and preferred. Manuscripts should be delivered in FINAL electronic form (1) at the time of meeting to the appropriate section VP or (2) no later than two weeks after the meeting at fshsproc@ashs.org.

Manuscripts to be considered as “refereed” MUST be submitted electronically at the time of the meeting.

For all submissions, see complete Manuscript Preparation Guide for the Proceedings of the Florida State Horticultural Society at:

<http://www.fshs.org/Proceedings/FSHS%20Author%20Instructions.pdf>

* * * * *

**FSHS PAPER AUTHORS:
REMEMBER TO
E-MAIL FULL-LENGTH MANUSCRIPTS AT**

FHSHPROC@ASHS.ORG

BY JUNE 17, 2011

with copy to the sectional VP:

Citrus: Ryan Atwood, raatwood@ufl.edu

H&P: Alvin Cheng, alvin.cheng@jbtc.com

Krome MI: Gary England, gke@ufl.edu

OGL: Mike Orfanedes, morf@ufl.edu

Vegetable: Danielle Treadwell, ddtreadw@ufl.edu



FSHS STUDENT COMPETITIONS

FSHS offers two competitions for students: Student Best Oral Presentation (SBOPC) and Student Best Paper (SBPC). Awards for the SBOPC will be presented during the Annual Business Meeting at the 2011 FSHS annual meeting in St. Petersburg. The SBPC awards will be announced at the 2012 FSHS annual meeting in Delray Beach. Awardees will receive cash prizes and will be recognized in the Proceedings of FSHS. Students may participate in either or both competitions.

Student Best Oral Presentation Competition (SBOPC):

Entries in the SBOPC are marked in blue in the conference program. The number of entries in the SBOPC is limited to 15 and must be submitted to the sectional VP. Acceptance in the competition is on a first-come, first-serve basis. Participants are judged on importance of the subject to Florida horticulture, scientific merit, organization, awareness of current literature, fluency, clarity of presentation, effective use of figures and tables, report of conclusions, completeness, timing, and response to questions. For more information on the SBOPC competition, contact Jose Reyes at jireyes@ufl.edu.

Student Best Paper Competition (SBPC):

To participate in the SBPC, students must submit a manuscript (use author guidelines for the Proceedings of the FSHS) by email with the subject "Student Best Paper Competition" to fshsproc@ashs.org by June 17, 2011. Student papers will be published in the Proceedings of FSHS. Entries will be judged on relevance to Florida horticulture, scientific merit, experimental design rigor, literature review, completeness, and clarity. For more information on the SBPC competition, Carlene Chase at cachase@ufl.edu.

FSHS STUDENT SCHOLARSHIPS

Attention, students: **did you know that FSHS awards ten, \$200 scholarships to students attending the Annual Meeting?** To apply, submit a less-than-100-word statement describing the importance of attending the FSHS Annual Meeting to the achievement of your personal and professional goals and aspirations at fshs@crec.ifas.ufl.edu by May 23, 2011. The FSHS Board of Directors judges submissions and verifies that the awardees are eligible registered students who have registered for the Annual Meeting. Scholarship checks will be awarded during the annual business meeting; awardees must be registered and present to receive their scholarship check.

* * * * *

TECHNICAL PROGRAM SCHEDULE

POSTER SESSION

Bradley Burbaugh, Coordinator

(brad784@ufl.edu)

Evelyn “Prissy” Fletcher, Student Session Assistant

(treehugger@ufl.edu)

Mezzanine

Monday Morning Session (Authors at posters 7:30 – 8:15 am)

Fungicidal Management of Alternaria Leaf Spot on Parsley. D. D. Sui, UF/IFAS Palm Beach County Extension, West Palm Beach, FL and R.N. Raid, UF/IFAS Everglades Research and Education Center, Belle Glade, FL. [P-1-V-18]

Beginning Farmers: Hmong [sic] Grower Meeting Series. M.E. Henry, UF/IFAS Polk County Extension, Bartow, FL; C. Snodgrass, UF/IFAS Manatee County Extension, Palmetto, FL; and, A. Whidden, UF/IFAS Hillsborough County Extension, Seffner, FL. [P-2-V-19]

Vegetable Growers in the Suwannee Valley Optimize Fertilizer use by Implementing Best Management Practices. D. Fenneman, UF/IFAS Madison County Extension, Madison, FL; E. Toro, UF/IFAS Suwannee County Extension, Live Oak, FL; R. Hochmuth and M. Bauer, North Florida Research and Education Center-Suwannee Valley, Live Oak, FL; and, C. Vann, UF/IFAS Lafayette County Extension, Mayo, FL. [P-3-V-20]

Remove the Confusion of Pesticide Licensing. S. Haddock, UF/IFAS Hillsborough County Extension, Seffner, FL. [P-4-OGL-26]

Rain Lilies for Central Florida. M. D’Abreau, UF/IFAS Hillsborough County Extension, Seffner, FL; Z. Deng, R. Rixom, D. Schwaninger and N. West, UF/IFAS Gulf Coast Research and Education Center, Balm, FL. [P-5-OGL-27]

Pesticide Formulations: The Benefit of Interactive CORE Workshops. E.E. Harlow, UF/IFAS Duval County Extension, Jacksonville, FL. [P-6-OGL-28]

Making Impacts with the North Florida Annual Hay Field Day. C.B. Sanders, and B.J. Wilder, UF/IFAS Alachua County Extension, Gainesville, FL; D.L. Barber, UF/IFAS Columbia County Extension, Lake City, FL; J.W. Breman, UF/IFAS Florida Partnership for Water, Agriculture & Community Sustainability, Hastings, FL; M.S. Sweat and B. Burbaugh, UF/IFAS Duval County Extension, Jacksonville, FL; D. Fenneman, UF/IFAS Madison County

Extension, Madison, FL; S.A. Gaul, UF/IFAS Nassau County Extension, Callahan, FL; D.B. Nistler, UF/IFAS Clay County Extension, Green Cove Springs, FL; E.M. Toro, UF/IFAS Suwannee County Extension, Live Oak, FL; and, T.W. Wilson, UF/IFAS Bradford County Extension, Starke, FL. [P-7-SC-1]

Field Evaluation of Blueberry Pruning Techniques. R.A. Atwood, UF/IFAS Lake County Extension, Tavares, FL and G.K. England, UF/IFAS Sumter County Extension, Bushnell, FL. [P-8-K-13]

Soil Amendments Effects on Soil pH of Biosolids-impacted Soils. Maria L. Silveira, UF/IFAS Soil and Water Science Dept.; E.W. Jennings, UF/IFAS Multi-county Cooperative Extension, Dade City, FL; Bridget Carlisle, UF/IFAS Polk County Extension Service, Bartow, FL; and, Lindsey Wiggins, UF/IFAS Multi-county Cooperative Extension. (mlas@ufl.edu) [P-9-SC-2]

Agronomic Evaluation of Transgenic Sugarcane Lines Mediated with ScMV-CP Gene. Muqing Zhang^{1,2}, Xiaodong Tan², Miaohong Ruan², Rukai Chen² and Charles A. Powell¹; ¹UF/IFAS Indian River Research and Education Center, Ft. Pierce, FL; ²Synthetic Institute of Sugarcane, Fujian Agri. & Forestry Univ., Fuzhou, 350002, P.R. China. (mqzhang@ufl.edu) [P-10-V-21]

Uncapping the Power of Market Maker: All you Wanted to Know but Never Dared Ask. Allen Wysocki, UF/IFAS Food Resource Economics Dept., Gainesville, FL and Linda Landrum, UF/IFAS NFREC-Suwannee Valley, Live Oak, FL. [P-11-V-22]

* * * * *

NOTES

VEGETABLE SECTION

Danielle Treadwell, Presiding

(ddtread@ufl.edu)

Pei-Wen Huang, Student Section Assistant

(agnespei@ufl.edu)

Avery/Chancellor

Monday Morning Session (10:00 – 11:45 am)

10:00 Welcome and Introductions, Danielle Treadwell

A-Vegetable Pest Management

- 10:15 **Efficacy of Experimental and Registered Miticide Programs for Twospotted Spider Mite on Strawberry.** J.F. Price and C.A. Nagle, UF/IFAS Gulf Coast Research and Education Center, Wimauma, FL. (jfprice@ufl.edu) [V-1]
- 10:30 **Current Status of Melon Thrips (*Thrips palmi* Karny Thysanoptera: Thripidae) in South Florida.** D.R. Seal, UF/IFAS Tropical Research and Education Center, Homestead, FL. (dseal3@ufl.edu) [V-2]
- 10:45 **Yellow Traps for Assessing Diel Pattern of Density of Leafminer, *Liriomyza trifolii* (Diptera: Agromyzidae) and its Parasitoids, *Opius* spp. (Hymenoptera: Braconidae) and *Diglyphus* spp. (Hymenoptera: Eulophidae).** J. Li and D.R. Seal, UF/IFAS Tropical Research and Education Center, Homestead, FL; and G.L. Leibe, UF/FAS Mid-Florida Research and Education Center, Apopka, FL. (jli59@ufl.edu) [V-3]
- 11:00 **Evaluation of Herbicides for Management of Weeds in Sweet Basil (*Ocimum basilicum*).** David Sui, UF/IFAS Palm Beach County Extension, West Palm Beach, FL; D. Odero and R. Raid, UF/IFAS Everglades Research and Education Center, Belle Glade, FL; and, W.M. Stall, Horticultural Sciences Dept., Gainesville, FL. (dsui@ufl.edu) [V-4]
- 11:15 **Evaluation of Acibenzolar-S-Methyl and Silicic Acid for Control of Phytophthora Blight in Squash Caused by *Phytophthora capsici*.** S. Zhang, W. Klassen, X. Mo, UF/IFAS Tropical Research and Education Center, Homestead, FL; P. Ji, Dept. of Plant Pathology, Coastal Plain Experiment Station, Univ. of Georgia, Tifton, GA; and, A.J. Gevens, Dept. of Plant Pathology, Univ. of Wisconsin, Madison, WI. (szhang0007@ufl.edu) [V-5]

11:30 Evaluation of Sanitizing Agents to Control Fusarium Species on Infested Irrigation Stakes Used for Greenhouse Tomato Production. Tamika Garrick¹, A. Minott¹, C. Harmon², E. Toro³, R.C Hochmuth⁴ and C.R. Semer IV⁵. Doctor of Plant Medicine Program¹, UF/IFAS Plant Disease Clinic², UF/IFAS Suwannee County Extension³, UF/IFAS North Florida Research and Education Center- Suwannee Valley⁴, UF Clinical Trials Program, UF/IFAS, Gainesville, Florida⁵. (ronika2005@gmail.com) [V-7] (**Student Best Oral Presentation Competition Entry**)

11:45 End of morning session/Lunch **on your own** (at Shawn's or Alfresco's)

Monday Afternoon Session (1:20-5:45)

1:20 Welcome and Introductions, Danielle Treadwell

B-Cultural Practices

1:30 Reduced Incidence of Tomato Plants with Symptoms of Tomato Yellow Leaf Curl Virus Infection Grown on UV-Reflective Soil Mulch. D.J. Schuster, UF/IFAS Gulf Coast Research and Education Center, Wimauma, FL; and, J.P. Gilreath and P.R. Gilreath, PhytoServices, Greenville, SC. (dschust@ufl.edu) [V-6]

1:45 Snap Bean Variety Evaluations on Yield and Post-harvest Quality in Florida Sandy and Muck Soils. Crystal Snodgrass UF/IFAS Manatee County Extension, Palmetto, FL; M. Ozores-Hampton, UF/IFAS Southwest Florida Research and Education Center, Immokalee, FL; R. Raid, UF/IFAS Everglades Research and Education Center, Belle Glade; G. McAvoy, UF/IFAS Hendry County Extension, LaBelle, FL; and, D. Sui, UF/IFAS Palm Beach County Extension, West Palm Beach, FL. (crys21@ufl.edu) [V-8]

2:00 Growing and Marketing Beets at Local Green Markets in Southeast Florida, 2007-2011. Kenneth D. Shuler, Pei-Ann N. Shuler, Daniel G. Shuler, and Deanna V. Shuler, Stephen's Produce, Jupiter, FL. (skshuler@aol.com) [V-9]

2:15 Use of Real-Time Florida Automated Network Data in Support of Strawberry Cold Protection and Irrigation Scheduling. K. Morgan, UF/IFAS Southwest Florida Research and Education Center, Immokalee, FL, and William R Lusher, UF/IFAS Information Technology, Gainesville, FL. (rlusher@ufl.edu) [V-10]

2:30 Growing and Marketing Dandelion Greens at Local Green Markets in Southeast Florida, 2003-2011. Kenneth D. Shuler, Pei-Ann N. Shuler, and Stephen J. Shuler Nie, Stephen's Produce,

Jupiter, FL. (skshuler@aol.com) [V-11]

2:45 Response of Over-head Irrigated Snap Bean Yield to N Rates in North Florida. E. Simonne, Guodong “David” Liu and A. Gazula, UF/IFAS Horticultural Sciences Dept., Gainesville, FL; R. Hochmuth, L. Landrum, D. Gast, L.L. Davis, W. Laughlin, R. Randell, and M. Bauer, UF/IFAS North Florida Research and Education Center-Suwannee Valley, Live Oak, FL; C. Vann, UF/IFAS Lafayette County Extension Service, Mayo, FL; C. Saft and E. Toro, UF/IFAS Suwannee County Extension, Live Oak, FL. (guodong@ufl.edu) [V-12]

3:00 Vegetable Section Business Meeting, David Sui

3:15 Break

3:30 Bell Pepper Production under Protective Structures: Evaluation of Soilless Media, Container Types, and Granular Nitrogen Sources. Emmanuel Torres-Quezada, Carlos Zambrano-Vaca, and Bielinski M. Santos, UF/IFAS Gulf Coast Research and Education Center, Wimauma, FL. (etorres1618@gmail.com) [V-13] **(Student Best Oral Presentation Competition Entry)**

3:45 Effects of Cell Size on the Production of Containerized Strawberry Transplants in Florida. Pei-Wen Huang, B.M. Santos, and V.M. Whitaker, UF/IFAS Gulf Coast Research and Education Center, Wimauma, FL. (agnespei@ufl.edu) [V-14] **(Student Best Oral Presentation Competition Entry)**

4:00 Characterization and Management of Lenticel Disorders during Storage of Table Stock Potatoes (*Solanum tuberosum* L.). Mildred N. Makani, S.A. Sargent, D.J. Huber, UF/IFAS Horticultural Sciences Dept., Gainesville, FL ; and, J.A. Bartz, UF/IFAS Plant Pathology Dept., Gainesville,FL. [V-23] (mmakani@ufl.edu) **(Student Best Oral Presentation Competition Entry)**

4:15 Fruits and Vegetables Focus Team Meeting (G1C6), Steve Sargent

5:45 End of afternoon session

6:00 Industry Reception (Palm Court Foyer; *Included in paid conference registration*)

Tuesday Morning Session (10:00-11:45am)

10:00 Welcome and Introductions, David Sui, VP-elect (dsui@ufl.edu)

- 10:15 Evaluation of Freeze Protection Methods and Plant Establishment Methods for Strawberry Production in Florida.** Bielinski M. Santos, T.P. Salame-Donoso, and C.D. Stanley, UF/IFAS Gulf Coast Research and Education Center, Wimauma, FL; A.J. Whidden, UF/IFAS Hillsborough County Extension, Seffner, FL; C.A. Snodgrass, UF/IFAS Manatee County Extension, Palmetto, FL; and, M.B. Henry, UF/IFAS Polk County Extension, Bartow, FL. (bmsantos@ufl.edu) [V-15]
- 10:30 Effects of Oxygen Fertilization on Redox Potential of Flooded Soil and Growth of Basil.** Guodong Liu, UF/IFAS Horticultural Sciences Dept., Gainesville, FL; Yuncong Li, and Kati K Migliaccio, UF/IFAS Tropical Research and Education Center, Homestead, FL; and, Teresa Olczyk, UF/IFAS Miami-Dade County Extension Service, Homestead, FL. (guodong@ufl.edu) [V-16]
- 10:45 The Protected Agriculture Information Network (PAINet): Evaluation of Cultural Practices for Indeterminate Bell Pepper Production under Protective Structures in the Dominican Republic, Nicaragua, Honduras, Costa Rica, and El Salvador.** Bielinski M. Santos¹, T.P. Salame-Donoso¹, H.A. Obregon-Olivas², J.E. Inestroza³, R. Galeano³, M.G. Cuevas⁴, M.V. Saenz⁵, M. Martinez⁶, E.A. Torres-Quezada¹, and C.J. Mendez-Urbaz⁴. ¹UF/IFAS Gulf Coast Research and Education Center, Wimauma, FL; ²Agropecuaria San Antonio, Tecolostote, Nicaragua; ³Corporacion Dinant, Comayagua, Honduras; ⁴Instituto Dominicano de Investigaciones Agropecuarias y Forestales, Santo Domingo, Dominican Republic; ⁵Laboratorio de Tecnologia Poscosecha, Universidad de Costa Rica, San Jose, Costa Rica; ⁶Hidroexpo, San Salvador, El Salvador. (bmsantos@ufl.edu) [V-17]

11:00 Discussion

11:15 End of program.

12:00 Extension Luncheon (Fred's; *Event ticket required*)

Vegetable Section Posters:

Fungicidal Management of Alternaria Leaf Spot on Parsley. [P-1-V-18]

Beginning Farmers: Hmong [sic] Grower Meeting Series. [P-2-V-19]

Vegetable Growers in the Suwannee Valley Optimize Fertilizer use by Implementing Best Management Practices. [P-3-V-20]

Agronomic Evaluation of Transgenic Sugarcane Lines Mediated with *ScMV-CP* Gene. [P-10-V-21]

**** **

ORNAMENTAL, GARDEN AND LANDSCAPE SECTION

Michael Orfanedes, Presiding

(eask@ufl.edu)

Connie Johnson, Student Section Assistant

(cnjufhlhort82@yahoo.com)

Plaza A&B

Monday Morning Session (10:00 – Noon)

10:00 Welcome and Introductions, Mike Orfanedes

A-Garden and Landscape

- 10:15 **Identifying and Developing Non-invasive Varieties in Landscape Plants: Progress and Prospects.** Zhanao Deng, S.B. Wilson, G.W. Knox, and R. Freye, UF/IFAS Environmental Horticulture Dept., Gainesville, FL. (zdeng@ufl.edu) [OGL-1]
- 10:30 **Effects of Production Shade Levels and Cultivar Selection on Potted and Cut Caladium Performance in Interiorscapes.** Robert Stamps, UF/IFAS Environmental Horticulture Dept. (rstamps@ufl.edu) [OGL-2]
- 10:45 **The Assumed Effects of Cold Weather on the Flowering of Five Ornamental Trees in Southwest Florida.** Stephen Brown, Lee County Extension, Ft. Myers, FL. (brownsh@leegov.com) [OGL-3]
- 11:00 **Designing an Edible Landscape or Eat Your Yard.** Anita S. Neal, St. Lucie County Extension, Ft. Pierce, FL. (asn@ufl.edu) [OGL-4]
- 11:15 **Does it Pay to Have a Vegetable Garden in South Florida?** Adrian G. Hunsberger and M. Lamberts, UF/IFAS Miami-Dade County Extension, Homestead, FL. (aghu@ufl.edu) [OGL-5]
- 11:30 **Creating a Native Id Garden to Teach Sustainable Landscaping Concepts.** Michael Orfanedes, UF/IFAS Broward County Extension, Davie, FL. (morfanedes@broward.org) [OGL-6]
- 11:45 **Intense Blooming Days of Several Ornamental Flowering Trees of South Florida.** Stephen Brown, Lee County Extension, Ft, Myers, FL. (brownsh@leegov.com) [OGL-7]

12:00 End of morning session/Lunch **on your own** (at Shawn's or Alfresco's)

Monday Afternoon Session (1:20-5:45pm)

1:20 **Welcome and Introductions**, Mike Orfanedes

B-Water Quality and Nutrient Management

1:30 **Reinforcing Green Industry Best Management Practices Through an Interactive Landscape Field Day.** Ed Skvarch, UF/IFAS St. Lucie County Extension, Ft. Pierce, FL. (eask@ufl.edu) [OGL-8]

1:45 **Building Sustainable Water Supplies through Rainwater Harvesting.** BJ Jarvis, UF/IFAS Pasco County Extension, Dade City, FL. (bjjarvis@pascocountyfl.net) [OGL-9]

2:00 **Fertilizer Selection as a pH Management Tool in Floriculture Production.** Connie Johnson, P.R. Fisher and J. Huang, UF/IFAS Environmental Horticulture Dept., Gainesville, FL. (cnjuflhort82@yahoo.com) [OGL-10] **(Student Best Oral Presentation Competition Entry)**

2:15 **Review of Efficacy Tests for Chlorination of Irrigation Systems.** Rosa E. Raudales and P.R. Fisher, UF/IFAS Environmental Horticulture Dept., C.L. Harmon, UF/IFAS Plant Pathology Dept., and B.R. MacKay, ThomasBaine Ltd, New Zealand. (rosaraudales@ufl.edu) [OGL-12] **(Student Best Oral Presentation Competition Entry)**

2:30 **Chemistry of Copper for Algae Control in Irrigation Systems.** Gavin S. Mohammad-Pour, D.W. Haskell, J. Huang, and P.R. Fisher, UF/IFAS Environmental Horticulture Dept., Gainesville, FL. (gpour@ufl.edu) [OGL-11]

2:45 **Disinfectant Chemicals Used to Control Waterborne Pathogens are Deactivated by Peat Particles in Water.** Jinsheng Huang, D.P. Meador, D.B. Decio, W.E. Horner, and P.R. Fisher, UF/IFAS Environmental Horticulture Dept., Gainesville, FL. (huangj@ufl.edu) [OGL-13]

3:00 **OGL Sectional Business Meeting**, Jane Morse

3:15 Break

3:30 **Using Landscape BMP Training to Improve Water Quality.** Jane Morse, UF/IFAS Pinellas County Extension, St. Petersburg, FL. (jmorse@ufl.edu) [OGL-14]

3:45 **Components of Sustainable Production Practices for Container Plant Nurseries.** Alejandro Bolques, Florida A&M University Cooperative Extension, Gadsden County

Extension, Quincy, FL. (abol@ifas.ufl.edu) [OGL-15]

C-Mini-Forum: Sustainability in our Florida Landscape

- 4:00 Introduction and purpose
- 4:05 **Successful Implementation of Florida-friendly Landscaping in a Community Setting.** Lynn Barber, UF/IFAS Hillsborough County Extension, Seffner, FL and B. Niemann, UF/IFAS Florida Friendly Landscaping™ State Office, Gainesville, FL. (labarber@ufl.edu) [OGL-16]
- 4:50 **Lawncare USA: Putting Landscape Sustainability into Practice.** Juan Sierra, Lawncare USA, Weston, FL. (juan.sierra@lawncareusa.com) [OGL-17]
- 5:15 Group Discussion: How to improve sustainability?
- 5:45 Adjourn
- 6:00 **Industry Reception** (Palm Court Foyer; *Included in paid conference registration*)

Tuesday Morning Session (10:00-Noon)

- 10:00 **Welcome and Introductions**, Jane Morse, VP-elect (jvmorse@ufl.edu)

D-Pest Management & Pesticide Applicator Training

- 10:00 **Weevil Problems in the Landscape with Emphasis on *Myloccerus undatus* (Sri Lanka Weevil).** C. Mannion, UF/IFAS Tropical Research and Education Center, Homestead, FL and Henry Mayer, UF/IFAS Miami-Dade County Extension, Homestead, FL. (hmayer@ufl.edu) [OGL-18]
- 10:15 **Performance of Soil Solarization and Methyl Bromide in Sites Infested with Root-knot Nematodes.** Robert McSorley, UF/IFAS Entomology and Nematology Dept., Gainesville, FL. (mcsorely@ufl.edu) [OGL-19]
- 10:30 **Countertop Production of Predatory Mites for Public Distribution.** Juanita Popenoe, UF/IFAS Lake County Extension, Tavares, FL. (jpopenoe@ufl.edu) [OGL-20]
- 10:45 **Effect of Different Inorganic/synthetic Mulches on Weed Suppression during Soil Solarization.** H. K. Gill, UF/IFAS Citrus Research and Education Center, Lake Alfred, FL; and, R. McSorley, UF/IFAS Entomology and Nematology Dept., Gainesville, FL. (harsimrangill.pau@gmail.com) [OGL-21]
- 11:00 **Efficacy of Fungicides for Control of**

***Colletotrichum gloeosporioides* On Dendrobiums.** Robert T. McMillan, Jr. Kerry's Nursery, Inc., 21840 SW 258th Street Homestead, FL 33031. (rmcmillan@kerrys.com) [OGL-22]

11:15 Evaluation of Ten Groundcovers as a Landscape Banker Plant in the Absence of Prey. M.E. Henry, UF/IFAS Polk County Extension, Bartow, FL; S. Park-Brown, UF/IFAS Gulf Coast Research and Education Center, Plant City, FL and S. Arthurs, UF/IFAS Mid-Florida Research and Education Center, Apopka, FL. (mbhenry@ufl.edu) [OGL-23]

11:30 A Severe Outbreak of Xanthomonas on *Ficus elastica* in South Florida. E.V. Campoverde, UF/IFAS Miami-Dade County Extension, Homestead, FL and A.J. Palmateer, UF/IFAS Tropical Research and Education Center, Homestead, FL. (evcampoverde@ufl.edu) [OGL-24]

11:45 Using TurningPoint Technology to Train and Evaluate Knowledge Gain by Participants in a Limited Commercial Landscape Maintenance Program. Jane Morse, UF/IFAS Pinellas County Extension, St. Petersburg, FL. (jmorse@ufl.edu) [OGL-25]

12:00 End of program/**Extension Luncheon** (Fred's; *Event ticket required*)

Ornamental, Garden and Landscape Section Posters:

Remove the Confusion of Pesticide Licensing. [P-4-OGL-26]

Rain Lilies for Central Florida. [P-5-OGL-27]

Pesticide Formulations: The Benefit of Interactive CORE Workshops. [P-6-OGL-28]

**** * * * * *

2011 FSHS ANNUAL MEETING FACTS

Oral Invited Presentations	5
Poster Presentations	11
Oral Contributed Presentations	94
Citrus	22
Handling and Processing	18
Krome Memorial institute	12
Ornamental, Gardening & Landscape	25
Vegetables (including 9 Students')	18
In-service Training Presentations	4
Total Meeting Presentations	115

KROME MEMORIAL INSTITUTE

Gary England, Presiding

(gke@ufl.edu)

Libby Rens, Student Section Assistant

(libbyrens@gmail.com)

Plaza C

Monday Morning Session (10:00 – 11:45)

- 10:00 **Welcome and Introductions**, Gary England
- 10:15 **FamC30-5-1: A Potential Red Wine Selection for Florida.** Z. Ren, J. Lu, X. Xia and F. Bradley. Florida A&M University, Tallahassee, FL. (zxren@hotmail.com) [K-1]
- 10:30 **Resistance Screening for Crown Gall Disease in Various Grapevine Cuttings Inoculated by *Agrobacterium vitus* C493 and C4612.** Xia Xu¹, Jiang Lu¹, Jeong Ho Roh^{1,2}, Zhongbo Ren¹, Fitz Bradley¹, and Hong Huang. ¹Center for Viticulture and Small Fruit Research, Florida A&M Univ., Tallahassee, FL. ²National Horticultural Research Institute, RDA, Suwon 440-706, Korea. (jiang.lu@fam.u.edu) [K-2]
- 10:45 **Molecular Assessment of synchronized *in vitro* red cell cultures of American Native Grapes.** A.O. Ananga, S. Krastanova, S. Sutton and V. M. Colova (Tsolova), CESTA, Center for Viticulture and Small Fruit Research, Florida A&M Univ., Tallahassee, FL. (anthony.ananga@gmail.com) [K-3]
- 11:00 **Genetic Transformation of Synchronized *in vitro* Muscadine Grape Cell Cultures.** S. Sutton, S. Krastanova, A. Ananga, S. Leong and V. Colova (Tsolova), Center for Viticulture and Small Fruit Research, College of Engineering Sciences, Technology and Agriculture, Florida A&M University, Tallahassee, FL. (ssutton33@gmail.com) [K-4]
- 11:15 **Enhancing Resveratrol Content of Muscadine Grape Using External Stimulus.** Hemanth KN. Vasanthaiah, D. Kambiranda and S.M. Basha, Plant Biotechnology Laboratory, Center for Viticulture and Small Fruit Research, Florida A&M Univ. Tallahassee, FL. (hemanth.vasanthaiah@gmail.com) [K-5]
- 11:30 **Leaf Net CO₂ Assimilation and Electrolyte Leakage and Alcohol Dehydrogenase Activity in Roots of Mamey Sapote (*Pouteria sapota*) Trees as Affected by Root Zone Oxygen.** M.T. Nickum¹, Jonathan H. Crane¹, B. Schaffer¹ and F.S. Davies². ¹UF/IFAS Tropical Research and Education Center, Homestead, FL. ²UF/IFAS

Department of Horticultural Sciences, Gainesville.
FL. (jhcr@ufl.edu) [K-6]

11:45 End of morning session/Lunch **on your own** (at Shawn's or Alfresco's)

Monday Afternoon Session (1:20-4:30pm)

1:20 **Welcome and Introductions**, Gary England

1:30 **Fertilizer Rates, Application Timing, Growth, and Yields of Papaya Plants in North Central Florida.** F.S. Davies¹, Jonathan H. Crane², B. Schaffer², K. Migliaccio² and G. Zalman¹. ¹UF/IFAS Horticultural Sciences Dept., Gainesville, FL. ²UF/IFAS Tropical Research and Education Center, Homestead, FL. (jhcr@ufl.edu) [K-7]

1:45 **Time after Scion Harvest and Grafting Method Influence Graft Success Rate for Purple-fruited Pitanga (*Eugenia uniflora* L.).** M.M. Manners¹, John L. Griffis, Jr.² and T.G. McDonald³. ¹Florida Southern College, Lakeland, FL. ²Florida Gulf Coast Univ., Ft. Myers, FL. ³Univ. of Hawai'i, Manoa, HI. (jgriffis@fgcu.edu) [K-8]

2:00 **Field Evaluation of Blueberry Pruning Techniques.** Gary K. England¹, R.A. Atwood² and J.G. Williamson³. ¹UF/IFAS Sumter County Extension, Bushnell, FL. ²UF/IFAS Lake County Extension, Tavares, FL. ³UF/IFAS Horticultural Sciences Dept., Gainesville, FL. (gke@ufl.edu) [K-9]

2:30 **Pomegranate in Florida for Commercial Enterprises and Homeowners.** William S. Castle, J.C. Baldwin and M. Singh, UF/IFAS Citrus Research and Education Center, Lake Alfred, FL. (bcastle@ufl.edu) [K-10]

2:45 **Optimizing Fruit Spacing in Florida Peach Production.** G.K. England¹, R.A. Atwood² and Mercy Olmstead³. ¹UF/IFAS Sumter County Extension, Bushnell, FL. ²UF/IFAS Lake County Extension, Tavares, FL. ³UF/IFAS Horticultural Sciences Dept., Gainesville, FL. (mercy1@ufl.edu) [K-11]

3:00 **Krome Memorial Institute Business Meeting**, Gary England

3:15 Break

3:30 **Performance of Blueberry Cultivars under High Tunnels.** Teresa P. Salame-Donoso and B.M. Santos, UF/IFAS Gulf Coast Research and Education Center, Wimauma, FL. (terrych@gmail.com) [K-12]

4:15 **Discussion**

4:30 End of afternoon session/End of program

6:00 **Industry Reception** (Palm Court Foyer; *Included in paid conference registration*)

Tuesday Morning

12:00 **Extension Luncheon** (Fred's; *Event ticket required*)

Krome Memorial Section Poster:

Field Evaluation of Blueberry Pruning Techniques. [P-8-K-13]

**** **

HANDLING & PROCESSING SECTION

Alvin Cheng, Presiding

(alvin.cheng@jbtc.com)

Francisco Loayza, Student Section Assistant

(francisco.loayza@ufl.edu)

Plaza D

Monday Morning Session (10:00 – 11:45am)

10:00 **Welcome and Introductions**, Alvin Cheng

10:15 **Habitual Orange Juice Intake Contributes to the Stability of Weight, Body Fat and Body Measurements in Humans.** J.Q. Silveira, C.G. Lima, Thaís Cesar. (tcesar@fctar.unesp.br) [HP-1]

10:30 **The Effect of Fruit Size and Health Status on Orange Juice Consumer Acceptance Attributes.** R.M. Goodrich, C.O. Ipechukwu, C.A. Sims, M.D. Danyluk and T. Spann. (opacino@ufl.edu) [HP-2] **(Student Best Oral Presentation Competition Entry)**

10:45 **Establishing CO₂ Tolerance of Pink Tomatoes in MAP at Elevated Handling Temperatures.** Angelos I. Deltsidis, Eleni D. Pliakoni and Jeffrey K. Brecht. (adeltsidis@ufl.edu) [HP-14] **(Student Best Oral Presentation Competition Entry)**

11:00 **Effect of Abscission Agent on Citrus Juice Quality.** M.D. Danyluk, L.M. Friedrich, and T.M. Spann. (MDDanyluk@ufl.edu) [HP-4]

11:15 **Stability of Headspace Volatiles in an Orange Juice-NaCl Matrix System at Room Temperature.** Elizabeth Baldwin, Jinhe Bai, and Anne Plotto. (liz.baldwin@ars.usda.gov) [HP-5]

11:30 **Food Safety in the Fresh Produce Industry: Current Status and Future Direction.** John M. Siddle (john.siddle@jbtc.com) [HP-6]

11:45 End of morning session/Lunch **on your own** (at Shawn's or Alfresco's)

Monday Afternoon Session (1:20-5:15pm)

- 1:20 **Welcome and Introductions**, Alvin Cheng
- 1:30 **Quantifying Norovirus Contamination and Removal from Produce and Food Contact Surfaces during Food Preparation and Handling.** Jennifer L. Cannon, C.P. Sharps, Qing Wang, R.I. Turk and C. Smith. (jcannon@uga.edu) [HP-7]
- 1:45 **Environmental Conditions Encountered during Distribution from the Field to the Store Affect the Quality of 'Albion' Strawberry.** Yun-Pai Lai and M. Cecilia N. Nunes. (Yun-Pai@poly.usf.edu) [HP-8]
- 2:00 **Potential for Grading, Sanitizing and Hydrocooling Fresh Strawberries.** Angelo P. Jacomino, Steven A. Sargent, Adrian D. Berry, and Jeffrey K. Brecht. (jacomino@ufl.edu) [HP-9]
- 2:15 **Detection of Fluorescent Compounds in Citrus Leaf Cankers.** John A. Manthey and Jan A. Narciso. (John.Manthey@ARS.USDA.GOV) [HP-10]
- 2:30 **Trichoderma Rot on 'Fallglo' Tangerine Fruit.** Cuifeng Hu, Erin Roskopf, and Mark A. Ritenour. (cuifenghu@ufl.edu) [HP-11]
- 2:45 **The Potential Role of New Citrus Postharvest Fungicides in Penicillium-resistance Management in Florida Packinghouses.** John Zhang. (Jzhang@citrus.state.fl.us) [HP-12]
- 3:00 **Handling & Processing Section Business Meeting**, Gregg McCollum
- 3:15 Break
- 3:30 **Development of Chromatography System for Simultaneous Measurement of Gas Components in Storage Atmosphere of Horticultural Crops.** Jinhe Bai and Elizabeth Baldwin. (Jinhe.Bai@ARS.USDA.GOV) [HP-13]
- 3:45 **Dietary Intervention with Orange Juice on the Oxidative Status of Patients with Chronic Hepatitis C.** Delfina A. Manjate, Ana Lúcia M. Nasser, Paulo Inacio da Costa, Thaís B. Cesar. (tcesar@fcfar.unesp.br) [HP-3]
- 4:00 **Shelf-Life of Vine Tomato (*Lycopersicon esculentum*) Stored at Non-chilling**

Temperature and Different Relative Humidity Levels. Debra Chilson, Astrid Delgado and M. Cecilia N. Nunes (dchilson@poly.usf.edu) [HP-15]

4:15 **Effect of Fruit Coating on Litchi Postharvest Shelf-Life.** Guiwen 'Alvin' Cheng and Daoming 'Kevin' Li. (alvin.cheng@jbtc.com) [HP-16]

4:30 **Pepper Bruising Increases with Lower Temperature and Higher Turgidity.** Jeffrey K. Brecht and Steven A. Sargent. (jkbrecht@ufl.edu) [HP-17]

4:45 **Sensory Evaluation of Tangerine Hybrids at Multiple Harvests.** Anne Plotto and Elizabeth Baldwin. (Anne.Plotto@ARS.USDA.GOV) [HP-18]

5:00 **Discussion**

5:15 End of afternoon session/End of program

6:00 **Industry Reception** (Palm Court Foyer; *Included in paid conference registration*)

Tuesday Morning

12:00 **Extension Luncheon** (Fred's; *Event ticket required*)

**** * * * * *

CITRUS SECTION

Ryan Atwood, Presiding

(raatwood@ufl.edu)

Eduardo Chica, Student Section Assistant

(echica@ufl.edu)

Vinoy Grand Ballroom

Monday Morning Session (10:00 – 11:45am)

10:00 **Welcome and Introductions**, Ryan Atwood

10:15 **Salinity Tolerance of Cleopatra Mandarin Seedlings and Two of its Trifoliata Hybrids, US-897 and x639.** Jim Syvertsen and Wije Bandaranayake, UF/IFAS Citrus Research and Education Center, Lake Alfred, FL. (jmsn@ufl.edu) [C-1]

10:30 **Measuring and Modeling Transpiration in Relation to Citrus Tree Size using Sap Flow Sensors.** Laura Waldo, Kirandeep Mann, Arnold Schumann, UF/IFAS Citrus Research and Education Center, Lake Alfred, FL. (ljwaldo@ufl.edu) [C-2]

- 10:45 Citrus Shoot Age and Flowering Potential.** L. Gene Albrigo and Eduardo J. Chica, UF/IFAS Citrus Research and Education Center, Lake Alfred, FL. (albrigo@crec.ifas.ufl.edu) [C-3]
- 11:00 NAA Thinning of 'W Murcott'.** Ryan Atwood, UF/IFAS Lake County Extension, Tavares, FL; Nick Faryna, Faryna Grove Care & Harvesting, Umatilla, FL; Ed Stover, USDA/ARS, Ft. Pierce, FL. (raatwood@ufl.edu) [C-7]
- 11:15 Lack of Transmission of Huanglongbing (HLB) by Citrus Seed.** Jim Graham, Evan Johnson, Diane Bright, UF/IFAS Citrus Research and Education Center, Lake Alfred, FL; Mike Irey, US Sugar Corp., Clewiston, FL. (jhgraham@ufl.edu) [C-5]
- 11:30 Starch Analyses of HLB-affected and Control Healthy Leaves Reveal Variations in the Amylose/Amylopectin Ratio.** Ed Etxeberria and Pedro Gonzalez, UF/IFAS Citrus Research and Education Center, Lake Alfred, FL. (eye@crec.ifas.ufl.edu) [C-6]
- 11:45** End of morning session/Lunch **on your own** (at Shawn's or Alfresco's)

Monday Afternoon Session (1:20-4:30pm)

- 1:20 Welcome and Introductions,** Ryan Atwood
- 1:30 Stimulation of Flowering in Basal Buds of Sweet Orange by Removal of Terminal Buds before Floral Induction.** Eduardo J. Chica and L. Gene Albrigo, UF/IFAS Citrus Research and Education Center, Lake Alfred, FL. (echica@ufl.edu) [C-4] **(Student Best Oral Presentation Competition Entry)**
- 1:45 Comparison of Copper Formulations for Control of Citrus Canker on 'Hamlin' Orange.** Jim Graham and Megan Dewdney, UF/IFAS Citrus Research and Education Center, Lake Alfred, FL; Henry Yonce, KAC Agricultural Research, Deland, FL. (jhgraham@ufl.edu) [C-8]
- 2:00 Foliar Sprays of Insecticides Targeted at Flushing Citrus to Control Asian Citrus Psyllid and Citrus Leafminer.** Jawwad A. Qureshi, Barry Kostyk and Philip A. Stansly UF/IFAS, Southwest Florida Research and Education Center, Immokalee, FL. (jawwadq@ufl.edu) [C-9]
- 2:15 Evaluation of Wind Speeds within a Central Florida Citrus Grove: Potential Implications for Pesticide Spray Applications.** W.C. Oswalt, UF/IFAS Polk County Extension, Bartow, FL; R.A. Atwood, UF/IFAS Lake County Extension, Tavares, FL; S.H. Futch and M.E. Rogers, UF/IFAS Citrus

Research and Education Center, Lake Alfred, FL.
(wcoswalt@ufl.edu) [C-10]

- 2:30 **A Summary of Nematode Soil Sampling Results From the Indian River Area in 2010-2011.** Timothy P. Gaver, UF/IFAS St. Lucie County Extension, Ft. Pierce, FL; Larry Duncan, UF/IFAS Citrus Research and Education Center, Lake Alfred, FL; and, Alex Truszkowski, DuPont Crop Protection. (tgaver.49@ufl.edu) [C-11]
- 2:45 **Cold Injury Following Horticultural Treatments to Overcome Juvenility in Citrus Seedlings.** Ed Stover, Greg McCollum, and Kim Bowman, USDA/ARS, USHRL, 2001 S. Rock Rd., Ft. Pierce, FL. (Ed.Stover@ARS.USDA.GOV) [C-12]
- 3:00 **Citrus Section Business Meeting**, Fritz Roka
- 3:15 Break
- 3:30 **Dolomitic-phosphate-rock-based Slow Release Fertilizer for Agriculture and Landscapes.** Y. G. Yang, Z. L. He, P. J. Stoffella and X. E. Yang UF/IFAS Indian River Research and Education Center, Fort Pierce, FL. (ygyang@ufl.edu) [C-13]
- 3:45 **Response of Citrus to Exogenously Applied Salicylate Compounds during Abiotic and Biotic Stresses.** Kirandeep Mann, Arnold Schumann, Timothy Spann, UF/IFAS Citrus Research and Education Center, Lake Alfred, FL. (mannkk@ufl.edu) [C-14]
- 4:00 **Quantification of Furanocoumarins and Acids in Grapefruit Hybrid Populations to Evaluate Their Relation and Assist Selection.** Chunxian Chen, Fred Gmitter Jr., UF/IFAS Citrus Research and Education Center, Lake Alfred, FL; Carl Haun and Paul Cancalon, Florida Department of Citrus, Lake Alfred, FL. (cxchen@ufl.edu) [C-15]
- 4:15 **Air Temperatures within a Central Florida Citrus Grove using Microsprinkler Irrigation for Cold Protection.** W.C. Oswalt, UF/IFAS Polk County Extension UF, R.A. Atwood, Lake County Extension Service, UF, and T.M. Spann, UF/IFAS Citrus Research and Education Center, Lake Alfred, FL. (wcoswalt@ufl.edu) [C-16]
- 4:30 **Discussion**
- 4:45 End of afternoon session
- 6:00 **Industry Reception** (Palm Court Foyer; *Included in paid conference registration*)

Tuesday Morning Session (10:00 – 11:45am)

- 10:00 **Welcome and Introductions**, Fritz Roka VP-elect (fmroka@ufl.edu)
- 10:15 **Economic Arguments for and against Tree Eradication to Control HLB**. Fritz Roka, UF/IFAS Southwest Florida Research and Education Center, Immokalee, FL. (fmroka@ufl.edu) [C-17]
- 10:30 **Balanced Mineral Nutrition Decreases Greasy Spot Incidence in Citrus**. Kirandeep Mann, Arnold Schumann, and Timothy Spann, UF/IFAS Citrus Research and Education Center, Lake Alfred, FL. (mannkk@ufl.edu) [C-18]
- 10:45 **Rehabilitation of HLB-infected Trees by Severe Pruning and Good Nutrition**. Bob Rouse, UF/IFAS Southwest Florida Research and Education Center, Immokalee, FL. (rrouse@ufl.edu) [C-19]
- 11:00 **New Somatic Hybrid Rootstock Candidates for Tree-Size Control and High Juice Quality**. J.W. Grosser and G.A. Barthe, UF/IFAS Citrus Research and Education Center, Lake Alfred, FL. (jgrosser@ufl.edu) [C-20]
- 11:15 **Update on the Advanced Citrus Production System in Florida**. Arnold Schumann, Kevin Hostler, Kirandeep Mann, and Laura Waldo, UF/IFAS Citrus Research and Education Center, Lake Alfred, FL. (schumaw@ufl.edu) [C-21]
- 11:30 **Optimal Replacement Times for Citrus Groves: The Use of Advanced Production Systems to Mitigate Endemic HLB**. Robert A. Morris and Ronald P. Muraro, UF/IFAS Citrus Research and Education Center, Lake Alfred, FL. (ramorris@ufl.edu) [C-22]
- 11:45 End of program
- 12:00 **Extension Luncheon** (Fred's; *Event ticket required*)

**** **

EXTENSION LUNCHEON SPEAKERS

Mr. Ted Campbell, 2011
Mr. Kevin Morgan, 2010
Dr. Jim Horne, 2009
Mr. Armando Campos, 2008
Mr. Ted Winsberg, 2007
Mr. Chuck Obern, 2006
Dr. Larry Arrington, 2005

IN-SERVICE TRAINING AND PRODUCER WORKSHOP

IMPACT OF RECENT LEGISLATION ON FLORIDA AGRICULTURE

*Steve Sargent, Aparna Gazula, Bob Hochmuth,
and Bielinski Santos, Co-organizers*
(sasa@ufl.edu)

Vinoy Grand Ballroom

- 1:30 **Welcome and Introductions** – Aparna Gazula, UF/IFAs Alachua County Extension, Gainesville, FL. (agazula@ufl.edu)
- 1:35 Pre-training test
- 1:45 **Impact of the Numeric Nutrient Criteria and Water Use Restrictions on Florida Agriculture**, Bill Bartnick, Environmental Administrator, Office of Agricultural Water Policy, Florida Dept. of Agriculture & Consumer Services, Tallahassee, FL.
- 2:30 **Impact of the “Fertilizer Bill” on the Florida Landscaping Industry**, Donald P. Rainey, UF/IFAS Florida-Friendly Landscaping™ Program, Sarasota, FL.
- 3:00 Break
- 3:15 Moderator: Gene McAvoy, UF/IFAS Hendry County Extension, LaBelle, FL. (gmcavoy@ufl.edu)
- 3:15 **Understanding the Audit Process for Fresh Produce: Which one do I need?** Kiley Harper-Larson, Food Safety Specialist, Hugh Branch, Belle Glade, FL.
- 4:00 **Impact of New Fumigant Regulations on the Horticulture Industry**, Andrew MacRae, Extension Weed Specialist, UF/IFAS Gulf Coast Research and Education Center, Wimauma, FL.
- 4:30 Questions & Answer Session
- 4:45 Post-training test
- 5:00 Adjourn. Have a safe trip home!



NOTES



VINOY RENAISSANCE RESORT MAP

PLAZA LEVEL

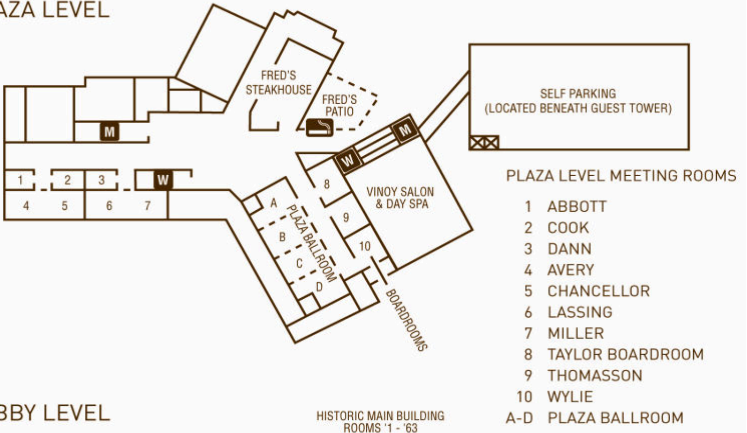

LOBBY LEVEL

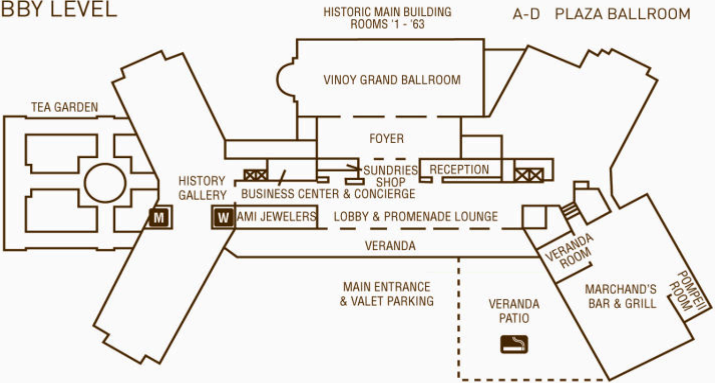

MEZZANINE LEVEL

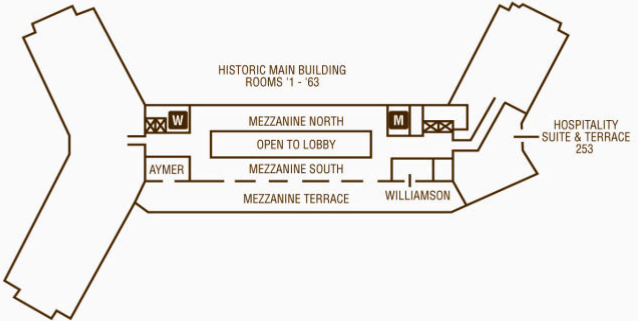

PALM COURT BALLROOM

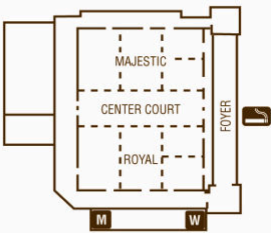

VINOY GOLF CLUB

